

PLANTA - COTA DE NÍVEL: 837,50
1:40

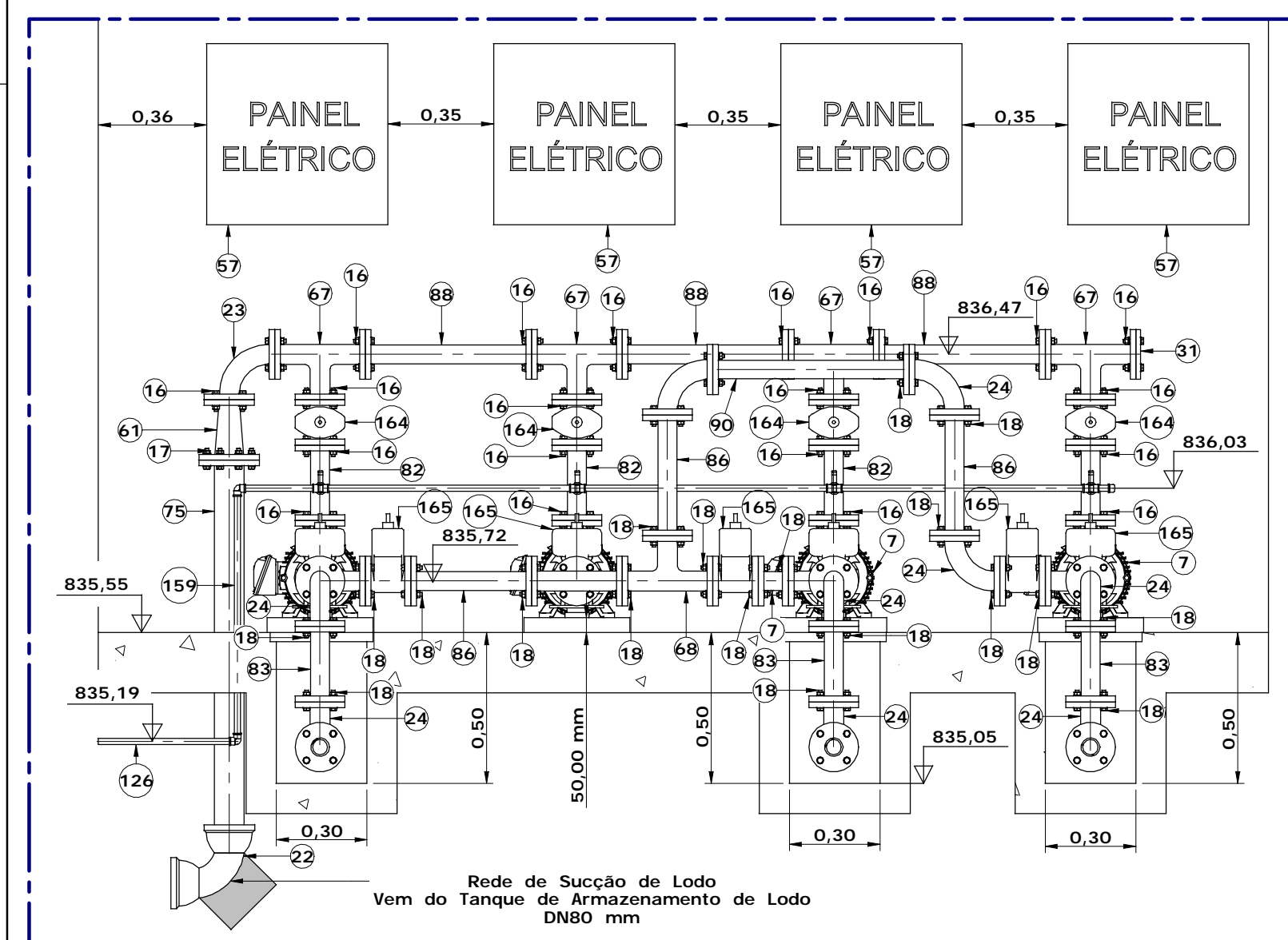

CORTE B-B
1:20

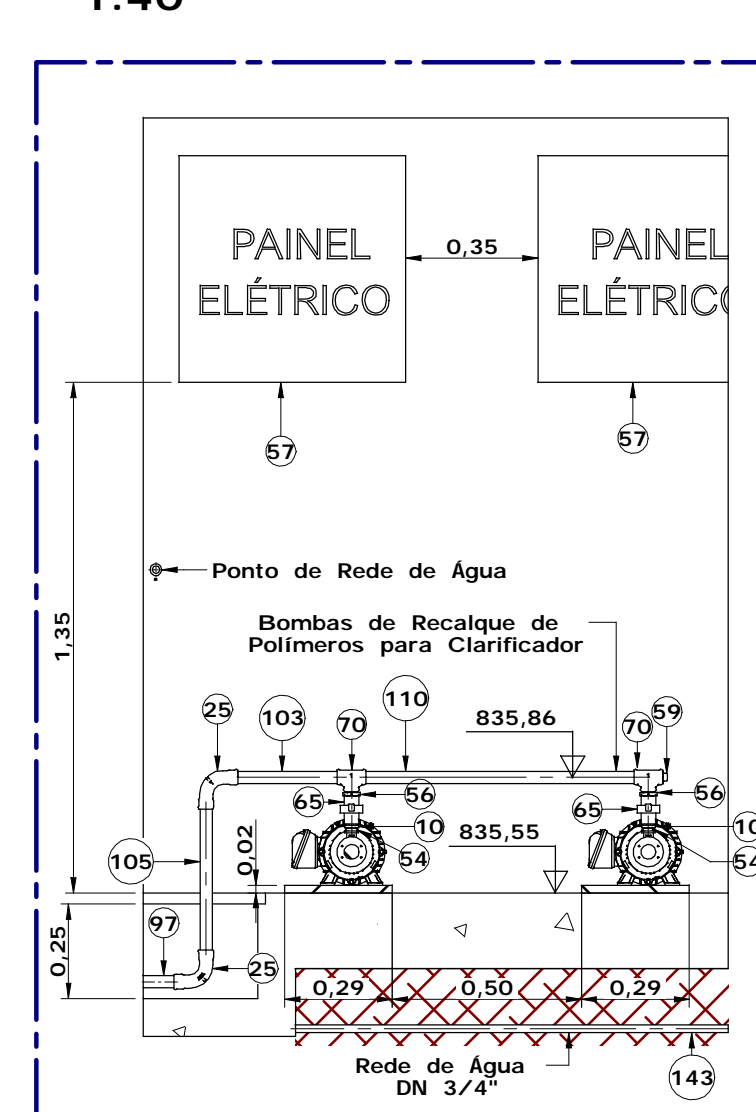

CORTE F-F
1:20

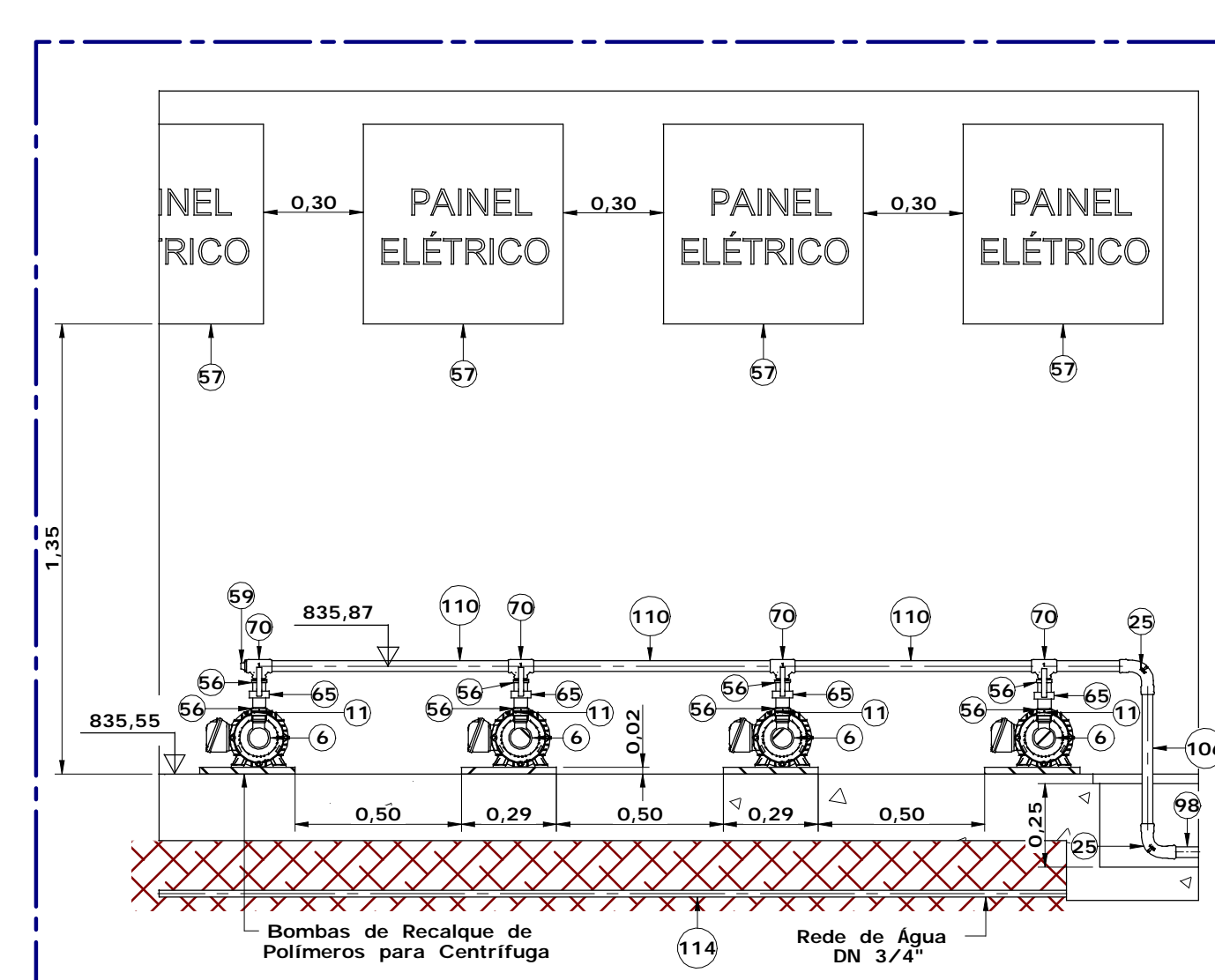

CORTE K-K
1:20

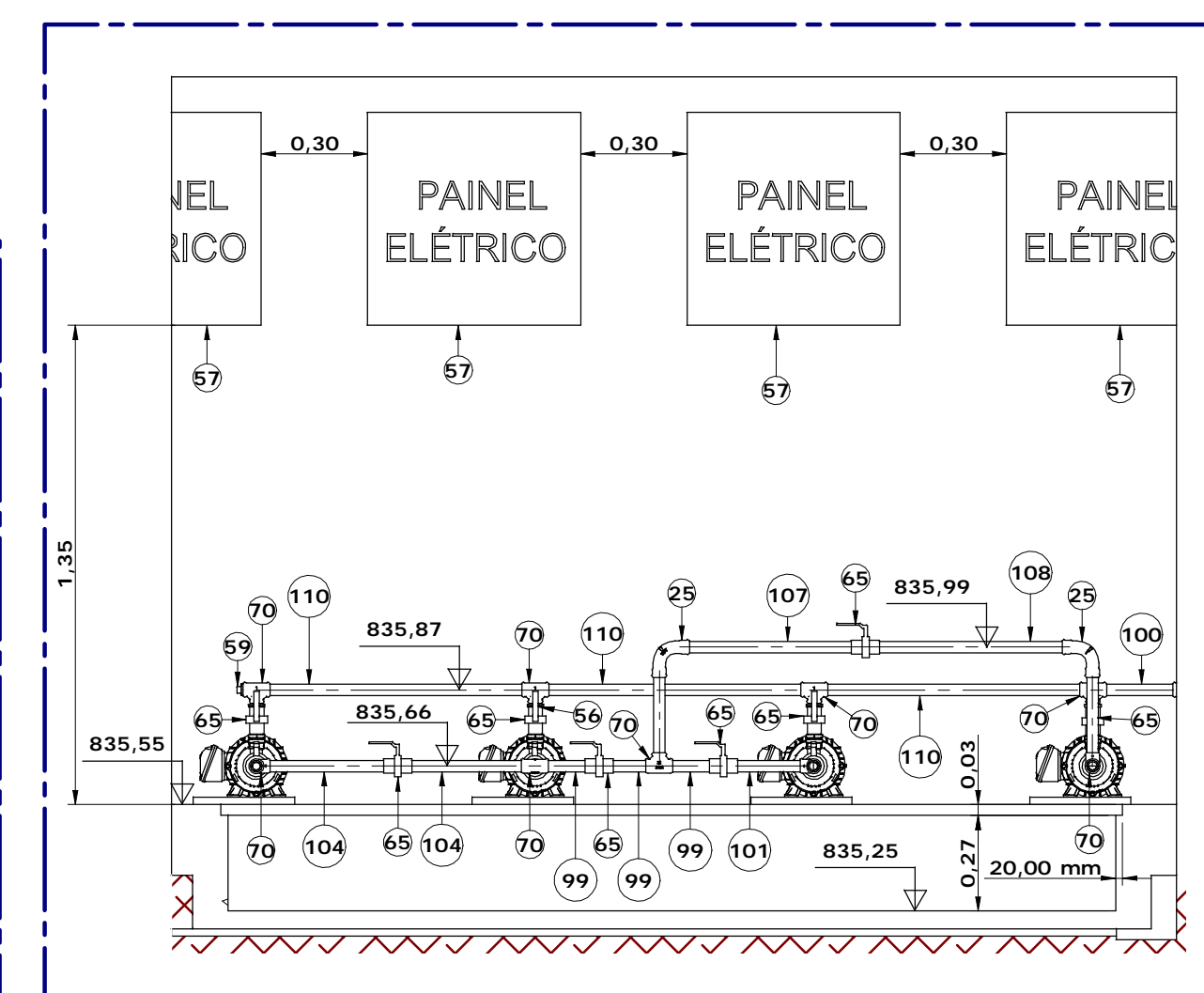

CORTE M-M
1:20

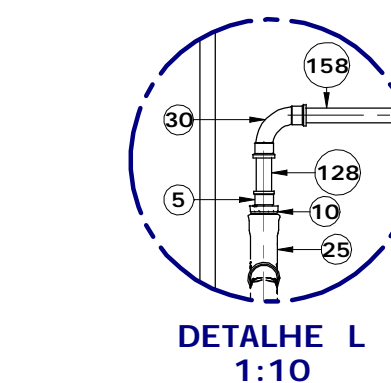

DETALHE L
1:10

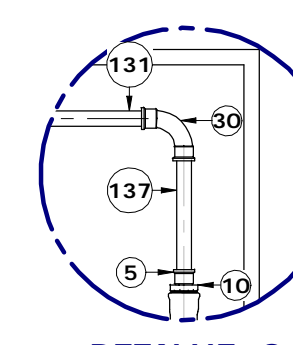

DETALHE O
1:10

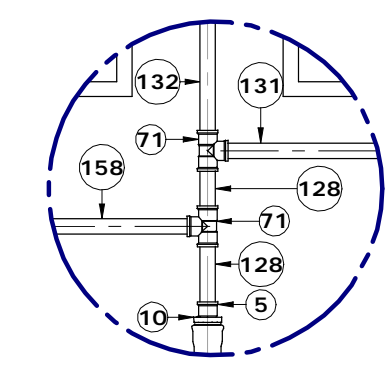

DETALHE P
1:10

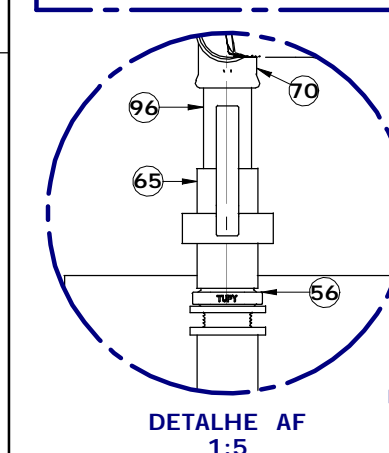

DETALHE AF
1:5

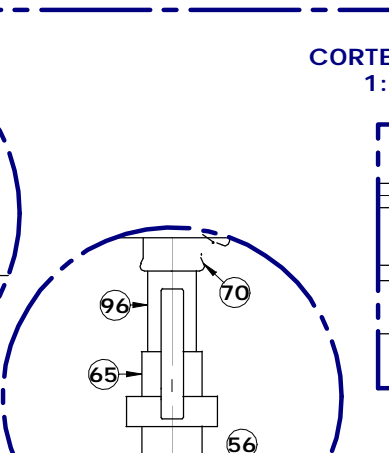

DETALHE AG
1:5

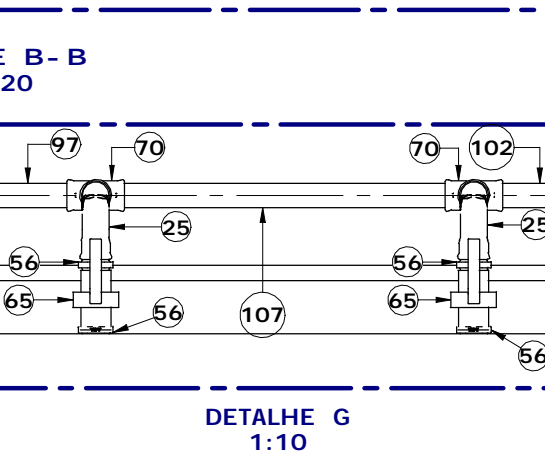

DETALHE G
1:10

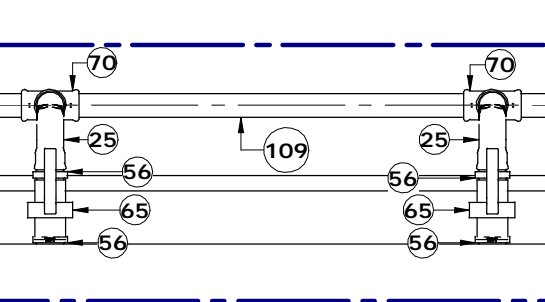

DETALHE I
1:10

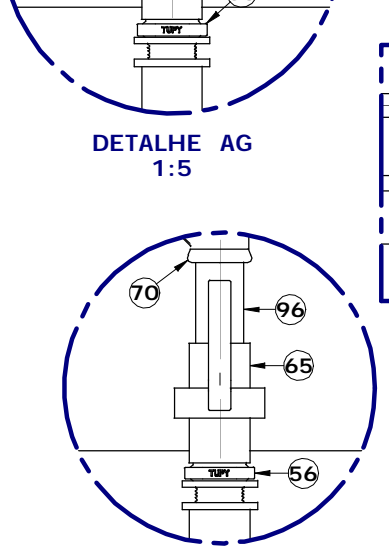

DETALHE AI
1:5

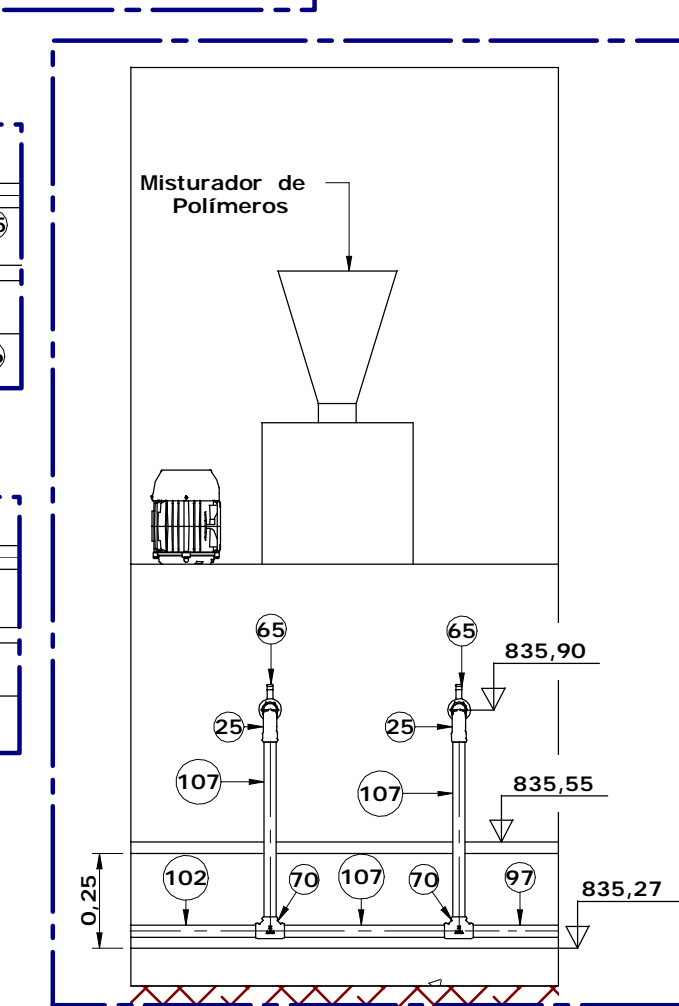

CORTE H-H
1:20

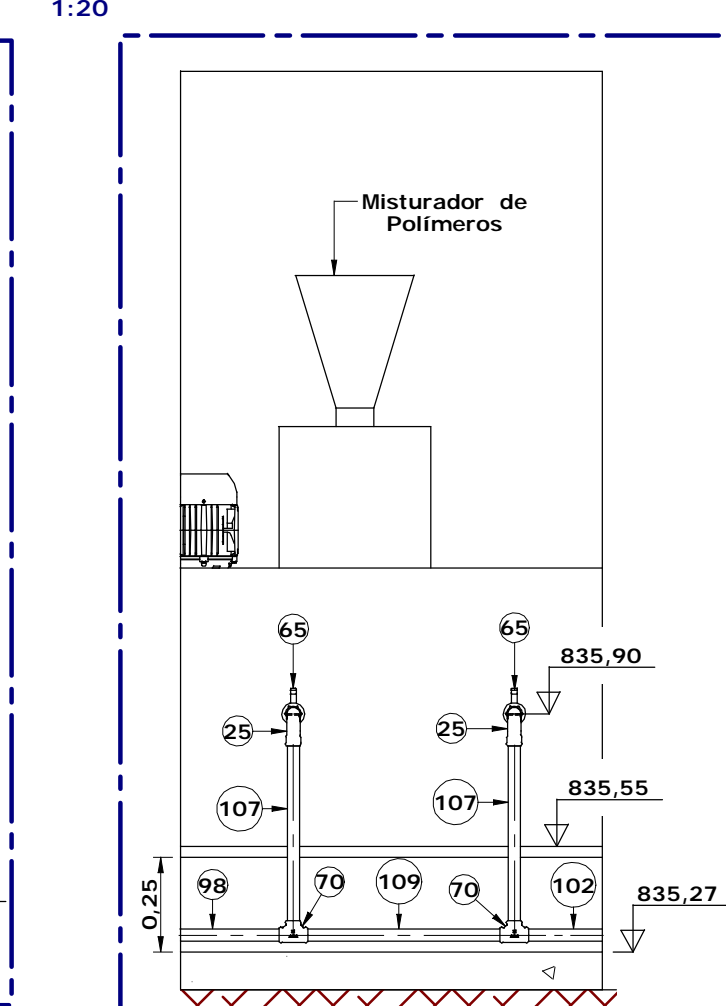

CORTE J-J
1:20

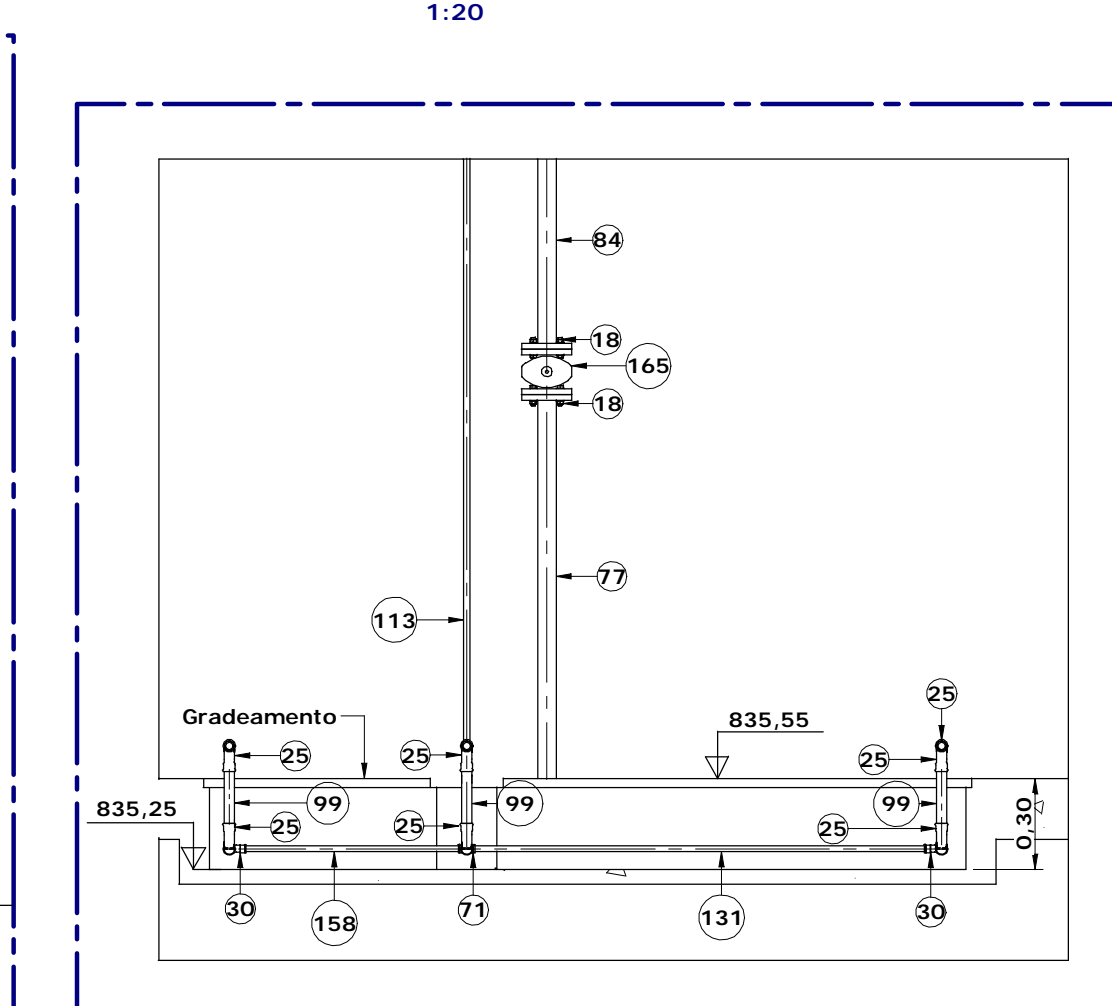

CORTE N-N
1:25

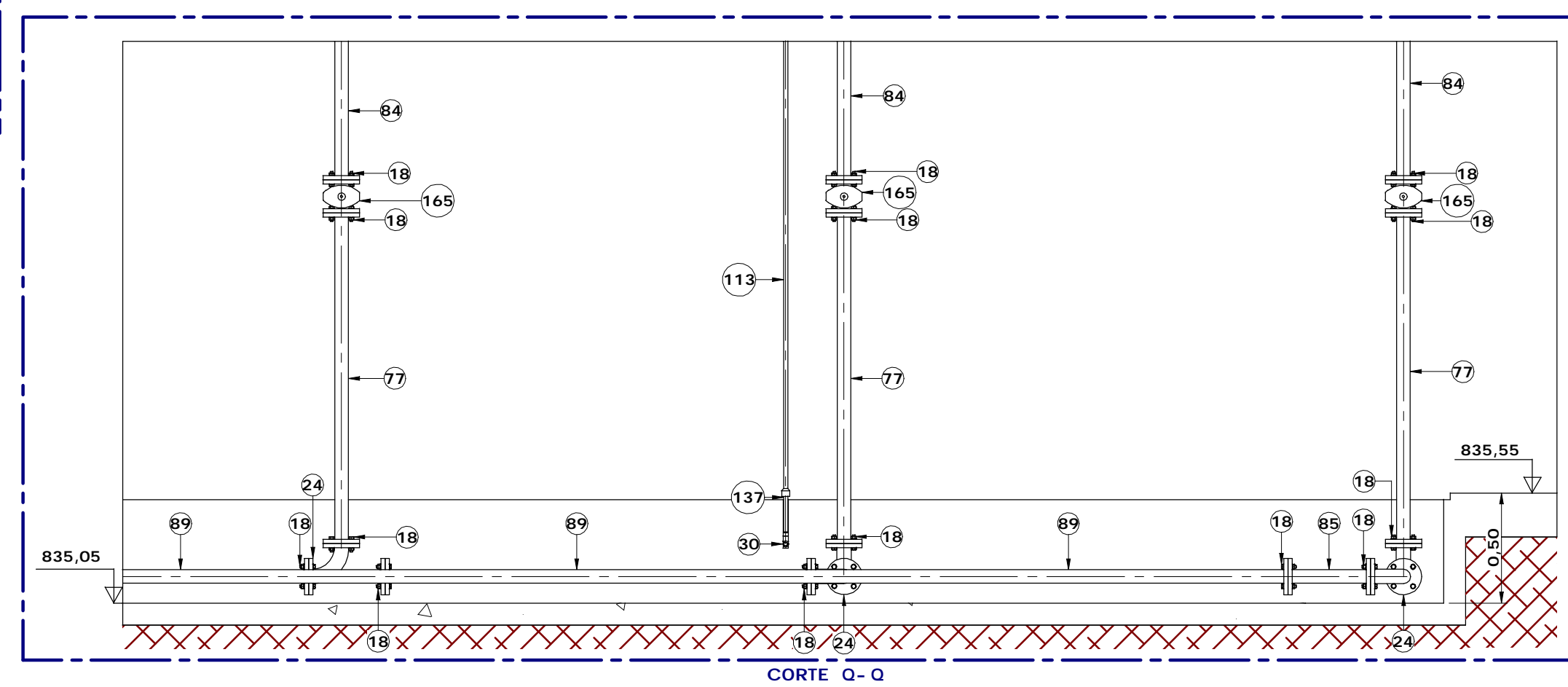

CORTE Q-Q
1:25

Executado por:
NOVAES ENGENHARIA
Rua Santa Cruz, nº956-01
Centroville - São Carlos - SP
CEP: 13500-680
Fone: (16) 3419-0906
Eng. Projetista: Luciano Farias de Novaes
Eng. Responsável: Luciano Farias de Novaes
ART: 92221220151640716
Desenhista: Rodrigo Akira Endo
Esc.: Indicadas
Data: Março/2017
Folha: 3/6
Versão: 01

DETALHAMENTO - PRÉDIO DE DESAGUAMENTO DE LODO
ESTÇÃO DE TRATAMENTO DE ÁGUA - ETA

PREFEITURA MUNICIPAL DE BOM JESUS DOS PERDÕES - SP